

VILLAGES AT JOHNSTOWN METROPOLITAN
DISTRICT NOS. 1-8 BOUNDARY MAP

- LGIDS:
 DISTRICT NO. 1: 66929
 DISTRICT NO. 2: 66930
 DISTRICT NO. 3: 66931
 DISTRICT NO. 4: 66932
 DISTRICT NO. 5: 66933
 DISTRICT NO. 6: 66934
 DISTRICT NO. 7: 66935
 DISTRICT NO. 8: 66936

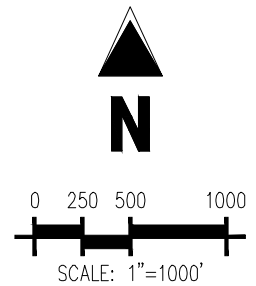
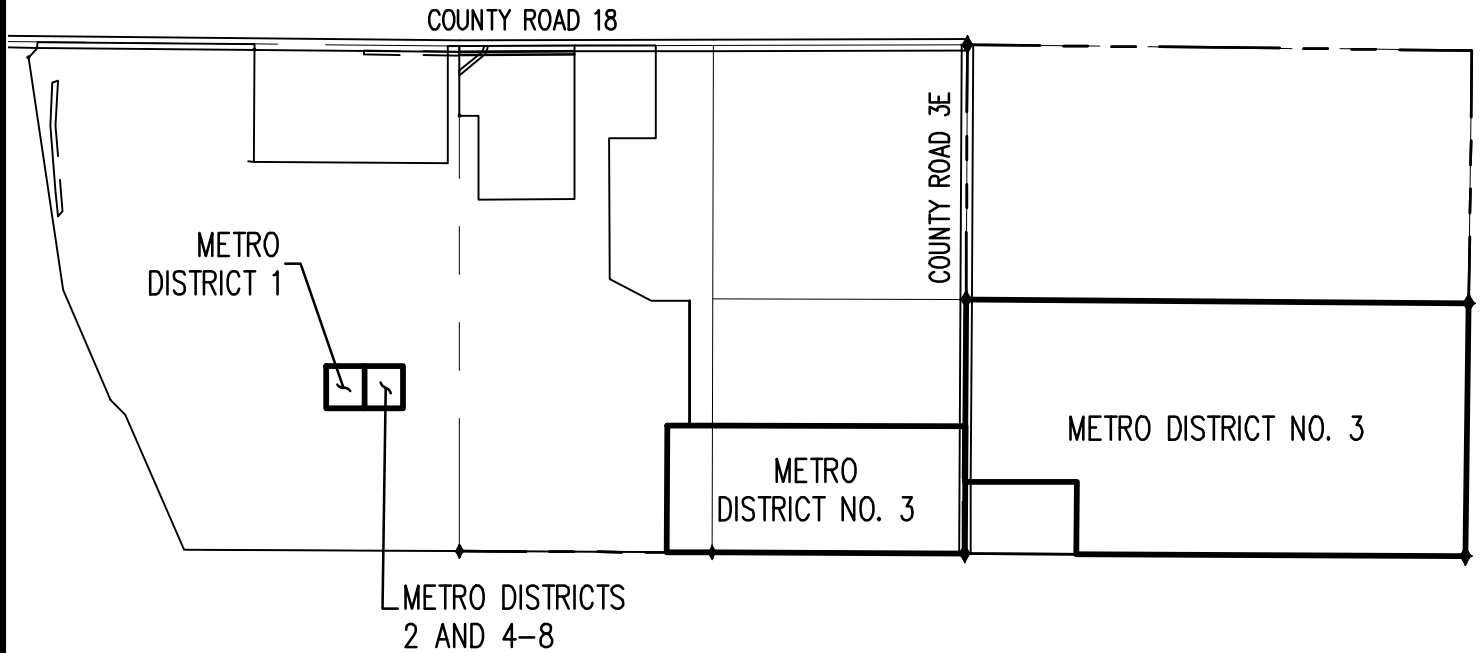

PART OF THE NORTHEAST QUARTER OF SECTION 27
 AND PART OF THE NORTH HALF OF SECTION 26
 T.5 N., R. 68 W., 6TH P.M., LARIMER COUNTY, COLORADO

VILLAGES AT JOHNSTOWN METROPOLITAN
 DISTRICT NOS. 1-8 BOUNDARY MAP

Project No:	JLH00001.10
Drawn By:	AN
Checked By:	FAK
Date:	11/20/2020

Galloway

5265 Ronald Reagan Blvd., Suite 210
 Johnstown, CO 80534
 970.800.3300 • GallowayUS.com